

INLET FLANGE DETAIL

10 connections to screw M8

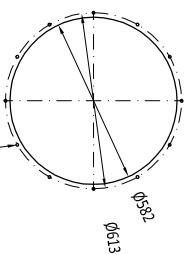

OUTLET FLANGE DETAIL

12 connections to screw M8



ITEM: KOMPAC AIR 4x3 CCD
 Q=12000 Nm³/h
 REV:04/2016/02/16

TECHNICAL SPECIFICATIONS

Weight	kg	1350
Number of filtering elements	nr	12
Filtering surface	m ²	226
Max working under pressure	Pa	5000
Working temperature	°C	-10<T<60
Pneumatic feeding	Ø	1"1/2 GAS
(ISO Class 2.4.1 according 8573-1:2000)		
Electric control panel feeding	230 V AC 50Hz	
Cartridges cleaning system	jet-pulse	
Number of cleaning valves	nr	4
Type of cleaning system valves	Ø1" 1/2 - 24 V DC	
Compressed air tank working pressure	bar	5
PERFORMANCE CHARACTERISTICS		
Nominal air flow	Nm ³ /h	12000
Nominal static pressure	Pa	2930
Nominal fan power	kW	15
Max compressed air consumption	Nl/shot	217